

MOTOR PLATES

MAT'L: 3/8 AL.

QTY: TWO REQUIRED

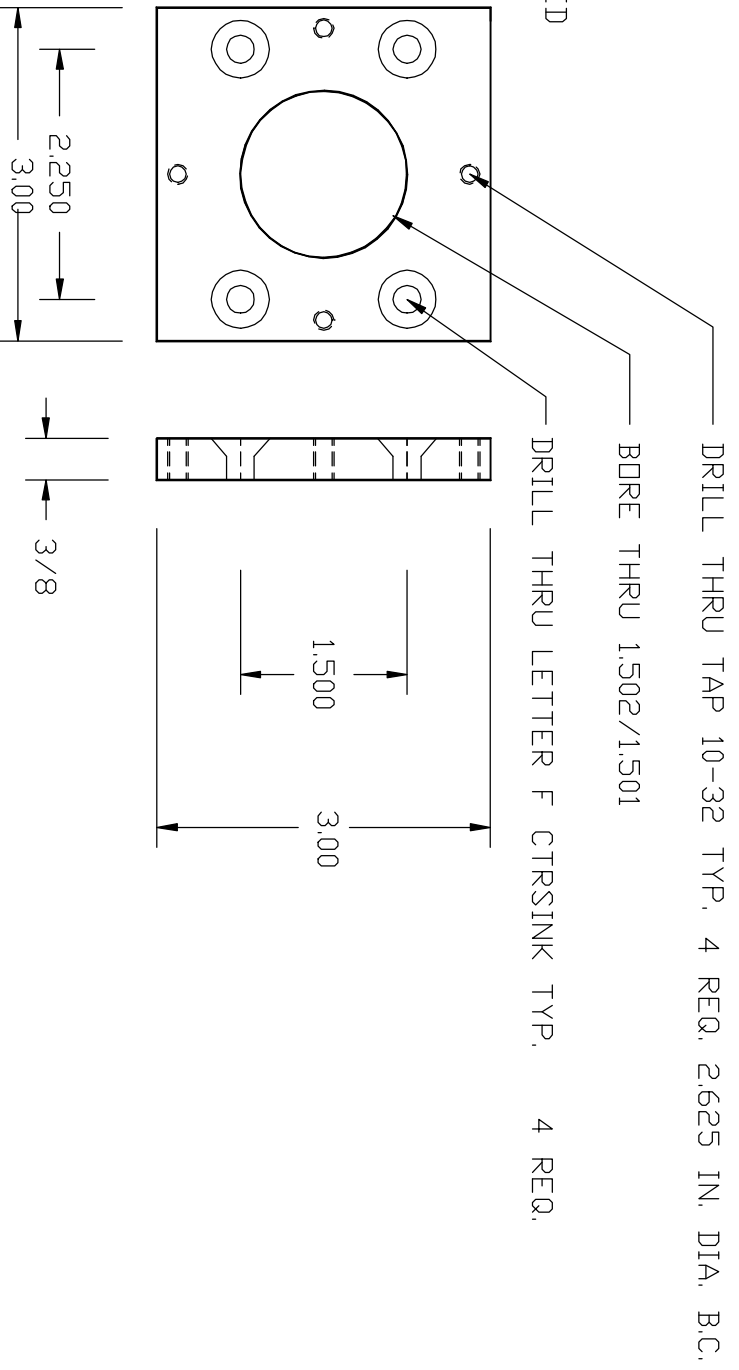

SPACERS

MAT'L: 3/4 AL. ROD

QTY: EIGHT REQUIRED

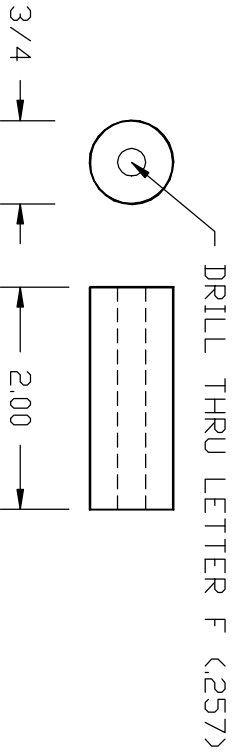

LEUSCHNER OBSERVATORY		UNIVERSITY OF CALIFORNIA - BERKELEY	
KATZMAN AUTOMATED IMAGING TELESCOPE			
TELESCOPE ASSEMBLY			
MOTOR MOUNTS			
DESIGNED BY	R. Treffers	DATE	12/23/94
DRAWN BY		SCALE	1:1
REVISION		DATE	
		REV	
		NO	KA11007